

# **LGF Quarterly Monitoring September 2023**



**CAMBRIDGESHIRE  
& PETERBOROUGH**  
COMBINED AUTHORITY



# Background

- The Business Board have supported several projects with different funding options:
  - 49 projects
  - 8 – equity Investment – £27,425,250, 36 – grants - £112,095,043, 5 – loans - £6,588,000
- There have been some projects that have either been cancelled post award or cancelled due to not being viable
- Evaluation of the remaining projects is ongoing with projects having monitoring end periods of between 3 & 30 years. The following slides outline the current position of the LGF outputs & outcomes
- As part of this monitoring period, a project visit was made to West Hub and a case study is included as part of this pack



## LGF Programme Progress

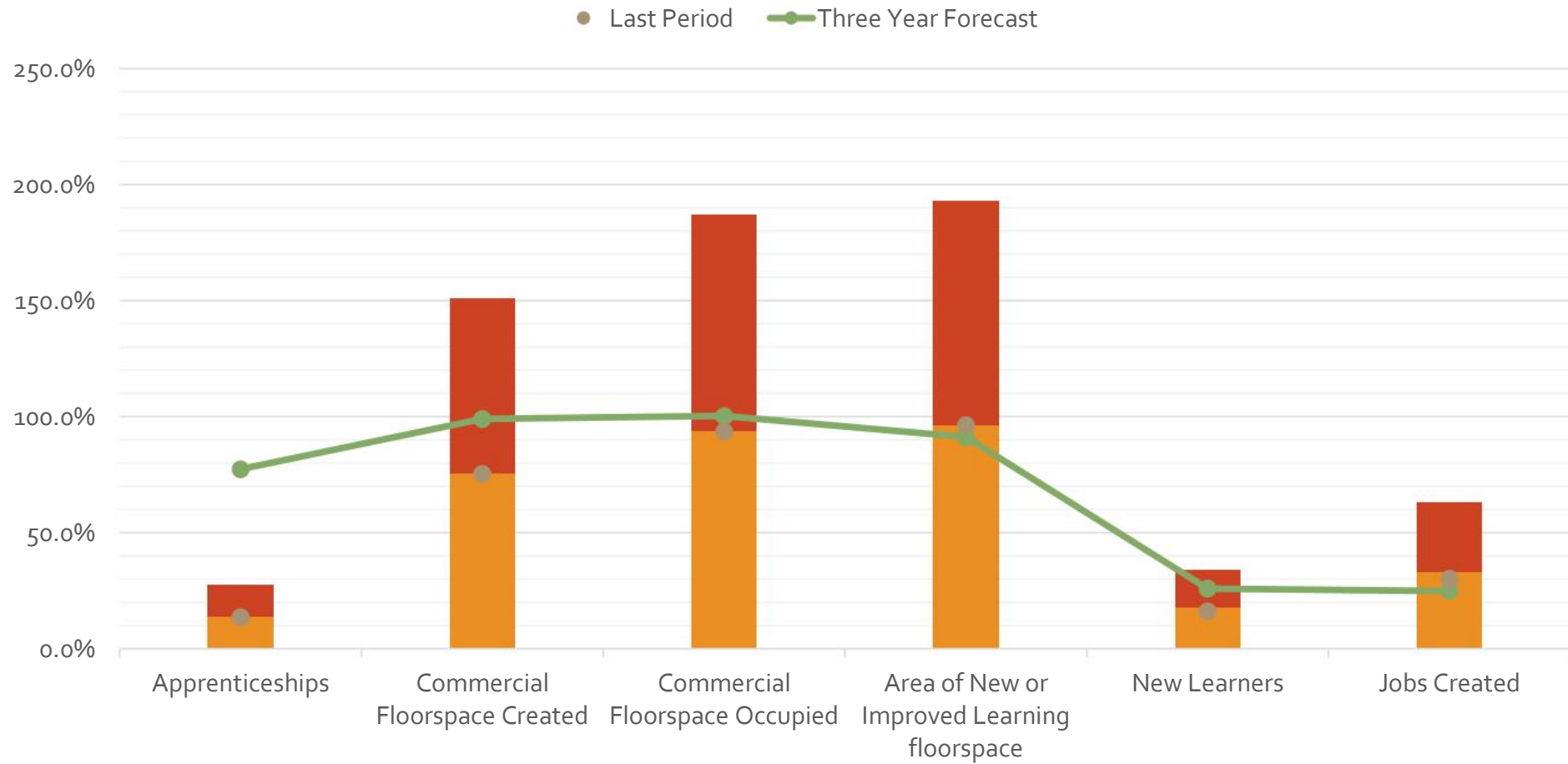



THE BUSINESS BOARD



CAMBRIDGESHIRE  
& PETERBOROUGH  
COMBINED AUTHORITY



UNIVERSITY OF  
CAMBRIDGE



# WEST HUB

- Initially known as “West Cambs Innovation Park”
- State-of-the-art multi-purpose facility on West Cambridge campus.
- Offers flexible spaces for working, teaching, library, catering, and a convenience store.
- Seamless design allows smooth transition between activities.

# Introduction to the West Hub

- Open to all, fostering a new approach to learning spaces and shared resources.
- Connects university members, businesses, and the community for study, work, collaboration, and socialization.



## Impact and Purpose:

- Addresses the lack of central location for academic and industry services.
- Positive influence on campus, hosting catering, post office, business events, and teaching spaces.
- Diverse guests regularly use meeting rooms and spaces.

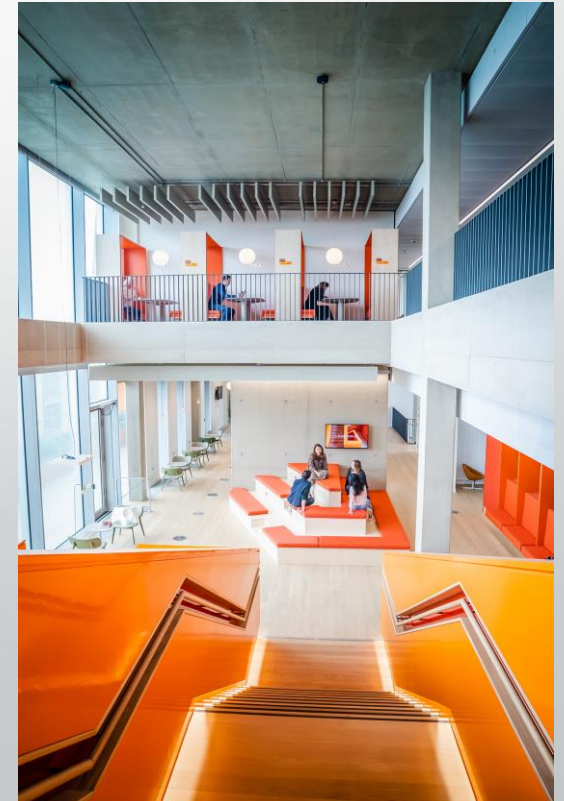



# Programming and Events

- Showcases the Hub through exhibitions, concerts, sports activities, and entrepreneurship gatherings.
- Highlights learning, collaboration, and socializing themes.
- Draws attention to the site as an attractive place for work, living, and collaboration.



## Unique Events:

- Examples include team-building with a neural engineering company, Spring Bunny Hunt, and interior design showcase.
- Events align with sustainability goals and values of the Hub.





## Success and Future Plans

- Successful first year with numerous events and thousands of guests.
- Focus on hosting more events, uniting University departments, enterprise, research, businesses, and residents.
- Key role in promoting growth and innovation at West Cambridge site

